

Department of Engineering
Tim Bryan, P.E., County Engineer

3137 South Liberty Street, Canton, MS 39046
Office (601) 790-2525 FAX (601) 859-3430

MEMORANDUM

January 5, 2021

To: Sheila Jones, Supervisor, District I
Trey Baxter, Supervisor, District II
Gerald Steen, Supervisor, District III
Karl Banks, Supervisor, District IV
Paul Griffin, Supervisor, District V

From: Tim Bryan, P.E., PTOE
County Engineer

Re: AT&T Utility Permit
Gluckstadt Road

The Engineering Department recommends approval of permit application for AT&T to install a fiber cable along and under Gluckstadt Road around the Lexington Drive intersection area to provide fiber optic service to Baptist Medical Clinic on Lexington Drive.

Revised: 2/14/2019



PERMIT APPLICATION FOR THE CONSTRUCTION OR ADJUSTMENT OF A UTILITY WITHIN COUNTY ROAD RIGHT-OF-WAY

Utility Information: Utility Name: AT&T MB7508@ATT.COM

Address: 370 CHURCH RD City/State/Zip: MADISON, MS 39110

Contact Person: MICHAEL BLACKWELL Contact's Phone: 601-859-3162

Project Information: County Road Name: GLUCKSTADT RD

(If located within more than one road right-of-way, use Appendix 1 for additional descriptions)

Beginning Location: N SIDE OF GLUCKSTADT RD Ending Location: S SIDE OF GLUCKSTADT RD

Length of Project: 394 FEET Section: 29 Township: 8-N Range: 2-E

Description of Work: BORING IN OF A FIBER CABLE ALONG AND UNDER GLUCKSTADT RD
AROUND THE LEXINGTON DR INTERSECTION AREA TO PROVIDE FIBER OPTIC SERVICE TO A
BAPTIST MEDICAL CLINIC ON LEXINGTON DR.

AT&T EWO 14J00148N

Check Box if Appendix 1 is to be included as a part of this Application

Whereas the above stated Utility makes application to the **Madison County Board of Supervisors** for a Construction Permit. Attached hereto are drawings and plans for the construction of the above facilities located within Madison County owned public rights-of-way. Once stamped by the Madison County Engineering Department, these plans shall not be changed or altered without written approval of the County Engineer, or his representative. A copy of the approved permit and plans shall be on-site at all times during construction.

The Applicant Utility shall comply with all policies, procedures and construction practices as outlined in *A Policy for The Accommodation of Utility Facilities within the Right-of-Way of all Public County Roads* (hereinafter referred to as the "Policy"), as adopted on November 1, 2005, by the **Madison County Board of Supervisors**, and which is hereby made a part of this Application Agreement.

If facilities are to be located within the Rights-of-Way of the County-Federal or State Aid System, Applicant Utility also agrees to comply with applicable provisions of *S.O.P. No. SA II-2-8, Accommodation of Utilities on Rights-of-Way*, issued by the State Aid Engineer and dated July 1, 2005.

The Applicant Utility understands and agrees that, except as herein granted, no right, title, claim, or easement to said road right-of-way is granted by the issuance of this permit. If this Utility is listed in the general provisions of the Policy, it will be adjusted to comply with same without cost to the County, unless the variance from the Policy has been approved by the granting of the Permit pursuant to this Application.

The Applicant Utility further understands that the Utility's engineering, plant, or other personnel will be responsible for the staking and construction supervision of the work set out above and as shown on the attached plans. If work impacts traffic in any way, the appropriate traffic control shall be installed per the *Manual of Uniform Traffic Control Devices*, Latest Edition.

The Applicant Utility understands that the County Engineer, or his representative, may issue a Stop Work Order at any time if it is deemed that site conditions are not suitable for construction or if any of the requirements of this permit are not being met.

Many County Roads have variable Rights-of-Way and/or no Right-of-Way at all and are maintained under a Prescriptive Easement. It is the sole responsibility of the Applicant Utility to verify the existence and limits of public rights-of-way. If none exists, it is the

responsibility of the Applicant Utility to acquire an easement for their Facilities from the applicable property owner(s). Madison County in no way verifies the limits of Right-of-Way as shown on the permit application.

The Applicant Utility shall be responsible for all future maintenance and repair of the facilities installed under this permit. The Applicant Utility shall make future adjustments to, or relocate, the facilities located within road or highway right-of-way when required for road or highway widening or other road or highway construction at no cost to Madison County. The Applicant Utility shall relocate said utilities within sixty (60) days of notification by County by registered mail, return receipt requested, unless otherwise designated by the County Engineer. Further, any maintenance, repair, or construction shall be done in such a manner as to occasion no unreasonable interference with the normal flow and safety to traffic and at the expense of the utility company. When reasonable care has been taken to locate said utility facilities within the right-of-way, the Applicant Utility understands that any damages caused by routine maintenance and construction by County forces shall be borne by the Applicant Utility.

The Applicant Utility further agrees to indemnify and hold Madison County harmless for any and all claims, accidents, damages, liabilities and expenses occasioned wholly, or in part, by any act or omission of applicant, its agents or employees. In case County shall, without fault on its own part, be made a party to any litigation commenced by or against applicant, then applicant shall protect and hold County harmless, and shall pay all costs, expenses and reasonable attorney's fees incurred or paid by County in connection with said litigation.

All underground facilities shall be installed at a depth equal to or greater than 48" below the lowest adjacent grade.

All pipes carrying liquid shall be encased under County maintained roads.

WITNESS the signature of the Applicant this the 5TH day of JANUARY, 2021.

By: Michael Blackwell
(Applicant Signature)

Title: MGR OSP PLNG & ENGRG DESIGN

Note: *Applicant must be an employee of the Utility named in this application. The Madison County Board of Supervisors will not recognize a Contractor, Subcontractor, Agent, or Consulting Engineer as the Applicant. Utility Company shall be fully responsible for all work performed under this application.*

I, or my authorized representative, have reviewed this application and determined that the drawing, sketches, and plans submitted by the Applicant meet the requirements of *A Policy for The Accommodation of Utility Facilities within the Right-of-Way of all Public County Roads.*

APPROVED
By: **By timothy.bryan at 11:21 am, Jan 13, 2021**
Tim Bryan, P.E.
County Engineer

AGREED TO AND APPROVED BY:

Madison County Board President

Date: _____

ENTERED INTO THE MINUTES OF THE BOARD OF SUPERVISORS OF MADISON COUNTY, MISSISSIPPI ON THIS _____ DAY OF _____, 20_____.

Appendix 1

County Road Name: _____
Beginning Location: _____ Ending Location: _____
Length of Project: _____ Section: _____ Township: _____ Range: _____
Description of Work: _____

County Road Name: _____
Beginning Location: _____ Ending Location: _____
Length of Project: _____ Section: _____ Township: _____ Range: _____
Description of Work: _____

County Road Name: _____
Beginning Location: _____ Ending Location: _____
Length of Project: _____ Section: _____ Township: _____ Range: _____
Description of Work: _____

County Road Name: _____
Beginning Location: _____ Ending Location: _____
Length of Project: _____ Section: _____ Township: _____ Range: _____
Description of Work: _____

County Road Name: _____
Beginning Location: _____ Ending Location: _____
Length of Project: _____ Section: _____ Township: _____ Range: _____
Description of Work: _____



VICINITY MAP
MADISON, MS



FROM I-55 TAKE EXIT 112 GLUCKSTADT RD. TRAVEL WEST
ON GLUCKSTADT RD 3,070 FT TO 102 LEXINGTON DR LOCATED
ON THE SOUTH SIDE OF GLUCKSTADT RD.

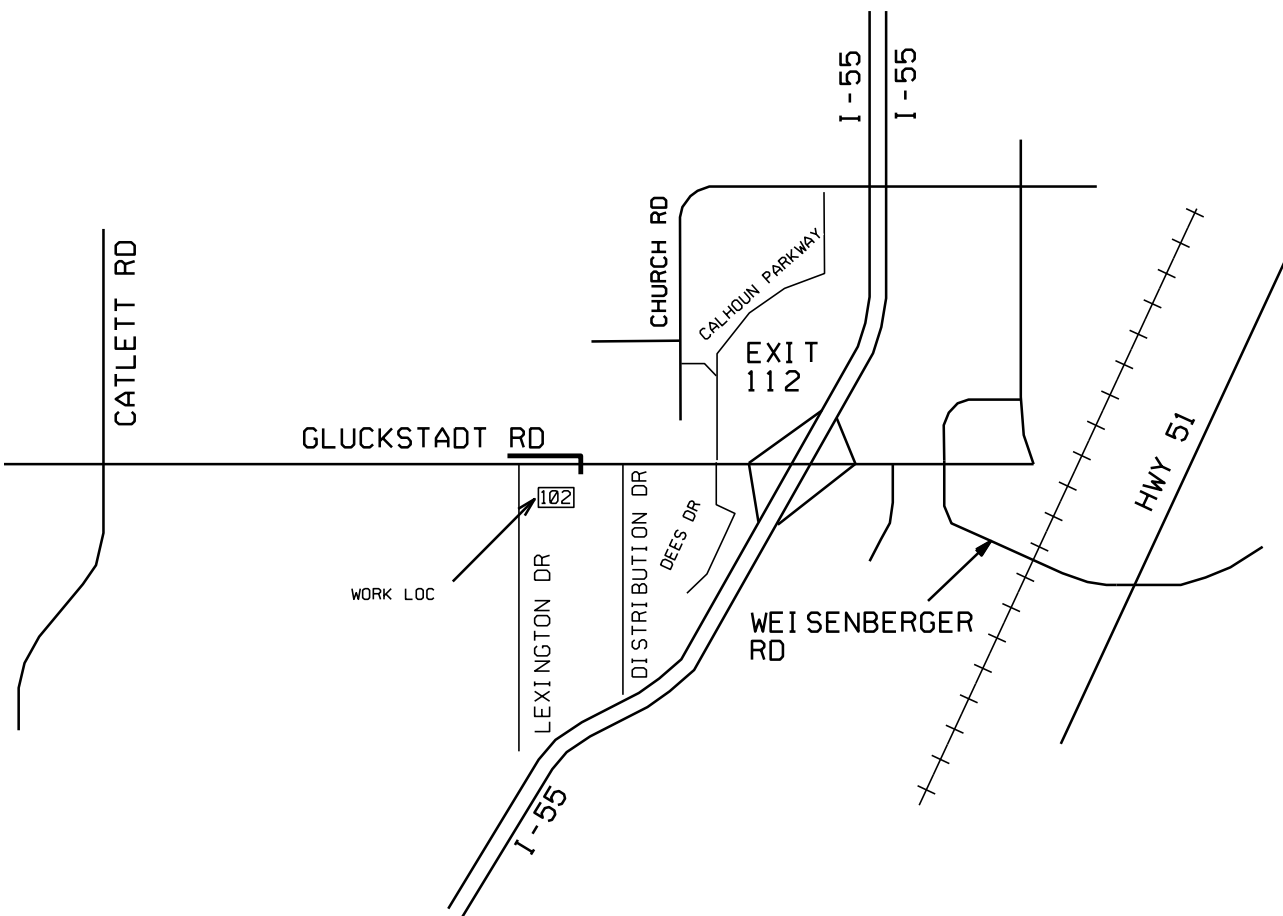

SYMBOL LEGEND		
Proposed	Existing	Description
		AERIAL CABLE
		BURIED CABLE
		BUR JOINT-TRENCH
		BST POLE
		POWER POLE
		ANCHOR & GUY
		PUSH BRACE
		ENCLOSURE
		ENCLOSURE
		MANHOLE
		PIPE/CONDUIT
		CABLE MARKER
		AERIAL SVC WIRE
		BURIED SVC WIRE
		JOINT-TRENCH SVC
	N/A	BORE
	N/A	CUT PAVEMENT
	N/A	SPLICING PIT
	N/A	TRENCH LENGTH

ATTSE	
PROPOSED TELEPHONE FACILITIES ON RIGHT OF WAY OF MADISON COUNTY	
MADISON, MS	
Exchange:	601856
Designer:	Blackwell, Michael
Phone:	601-859-3162
Authorization:	14J00148N
Dwg. <u> 1 </u> of <u> 3 </u>	

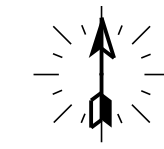

Note
PLACING CONTRACTOR:
MAINTAIN MIN. 4' BORE
DEPTH ON ALL R/W &
MIN. 2' BORE DEPTH ON
ALL PRIVATE PROPERTY
UNLESS OTHERWISE STATED
ON PRINTS.

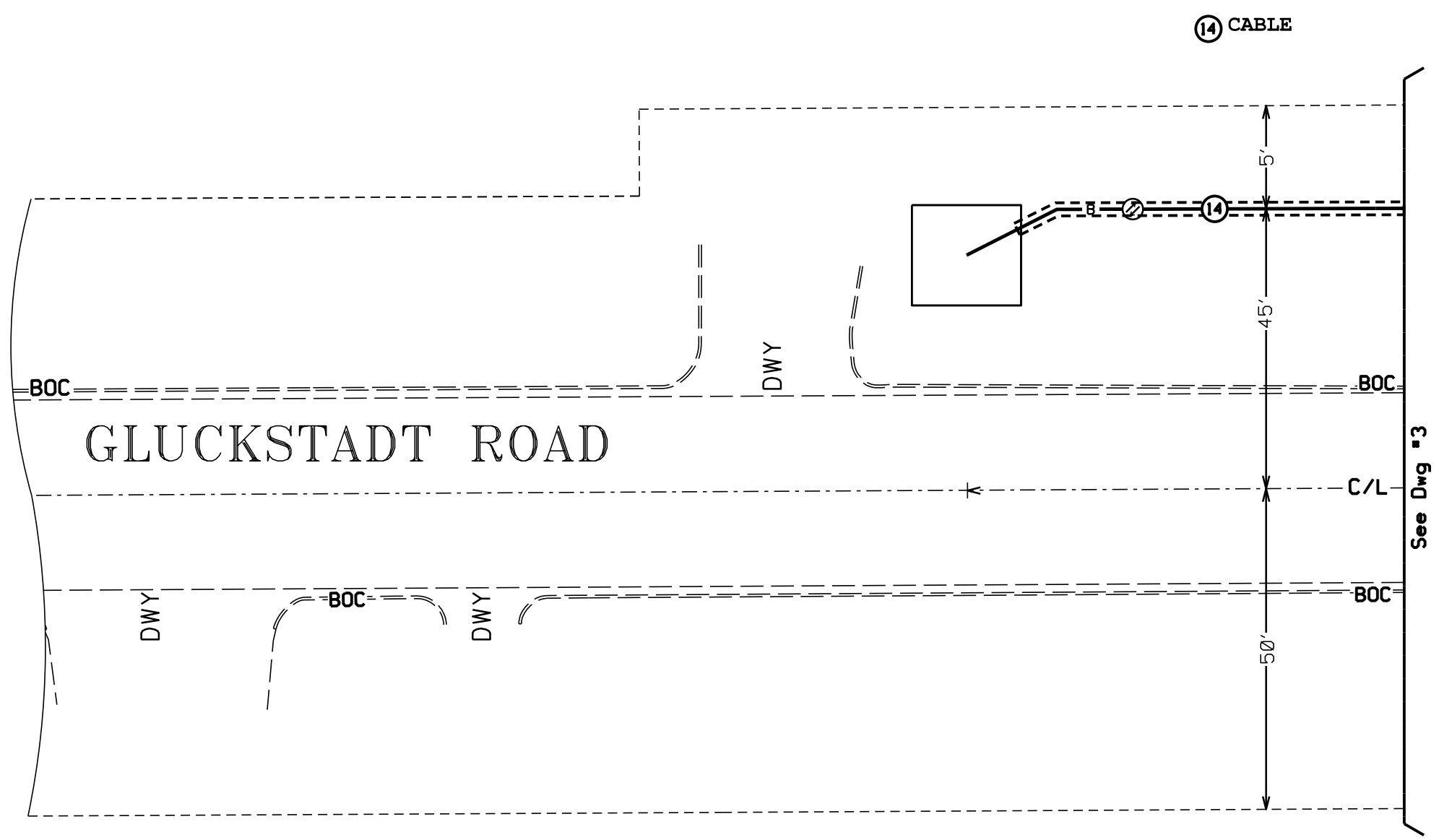

ATTSE	
PROPOSED TELEPHONE FACILITIES ON RIGHT OF WAY OF MADISON COUNTY	
MADISON, MS	
Exchange:	601856
Designer:	Blackwell, Michael
Phone:	601-859-3162
Authorization:	14J00148N
Dwg.	2 of 3

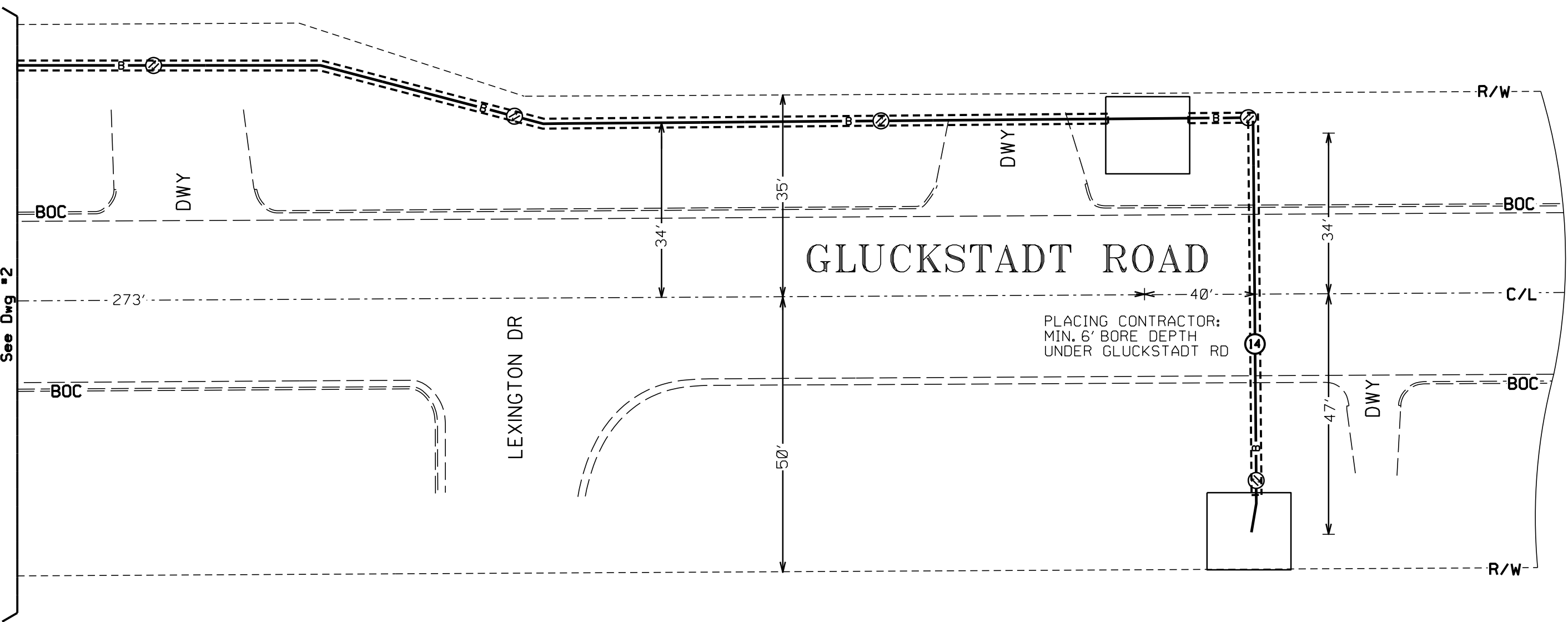

⑭ CABLE

Bore Detail For Gluckstadt Rd Facing East

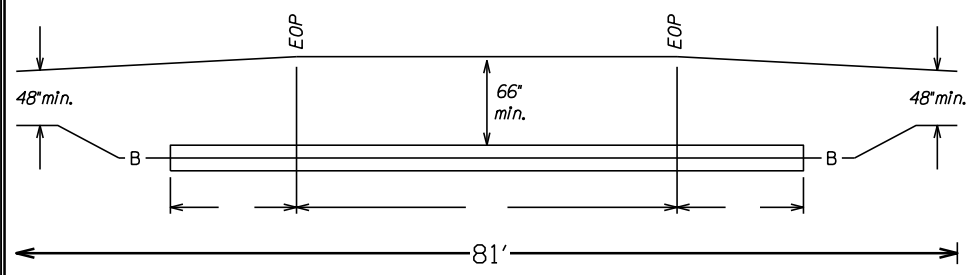

Note
 PLACING CONTRACTOR:
 MAINTAIN MIN. 4' BORE
 DEPTH ON ALL R/W &
 MIN. 2' BORE DEPTH ON
 ALL PRIVATE PROPERTY
 UNLESS OTHERWISE STATED
 ON PRINTS.

102 LEXINGTON DR LCON: ERICK BROWN 601-906-7032
SUITE 100
SUITE 200
SUITE 300

ATTSE	
PROPOSED TELEPHONE FACILITIES ON RIGHT OF WAY OF MADISON COUNTY	
MADISON, MS	
Exchange:	601856
Designer:	Blackwell, Michael
Phone:	601-859-3162
Authorization:	14J00148N
Dwg. <u> 3 </u> of <u> 3 </u>	